

IntePro[®] Hurricane Storm Panels



Durable 16mm IntePro Hurricane Storm Panels transmit diffused light that provide security and illumination rather than uncomfortable darkness.

IntePro Hurricane Storm Panels are lightweight, easily installed, and will not splinter like plywood.

Moisture will not cause your waterproof panels to warp or change in composition or shape. Cleaning can be accomplished with common household disinfecting products. Our Extended Life Formulation allows for outside storage so that the panels can be reused for many years.

IntePro Storm Panels have passed the criteria of Wind Zone 4 and Miami-Dade County set forth in ASTM E 1886-12 and ASTM E 1996-12a.

Features & Benefits

- Reusable
- Waterproof
- Translucent
- Lightweight
- Worry-free cleaning
- Easily handled
- Cost efficient
- Customizable
- DIY-friendly
- 100% recyclable material
- Splinter-free
- Moisture-proof
- Wind Zone 4-approved



Specifications

Width

Standard Sheet

- $\pm 1/8"$

Length

Standard Sheet

- 96": 0" to +1"

Squareness

(difference between diagonals)

Length of Standard Sheet

- 96": $\leq 1/2"$

Thickness

- $\pm 5\%$

Surface Treatment

- > 40 dyne/cm (16 mm)

Straightness

Length of IntePro is 96"

- If the ratio of Length to Width is 0 to ≤ 4 , the Tolerance is $\leq 3/16"$

Warp

(highest point of the sheet when place on a flat surface)

Length of IntePro is 96"

- If the Width is 48", the Tolerance is $< 3/4"$

Shipment Quantity

- -0% to + 5%

Easy Installation!

Standard size of IntePro 16mm material is available in a 4'x8' panel which is compatible with a variety of existing fasteners and channels, or, they can be cut to size and installed with common construction tools and fasteners. Custom sizes are available upon request.

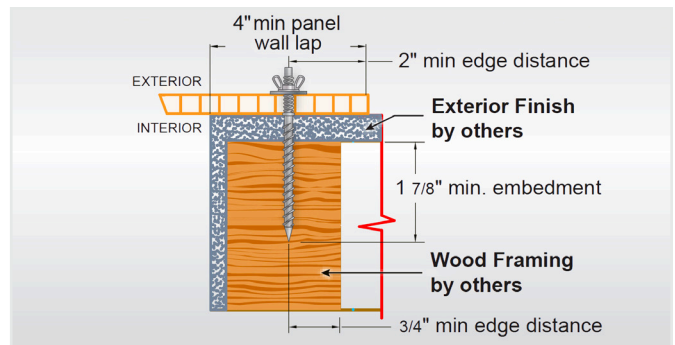
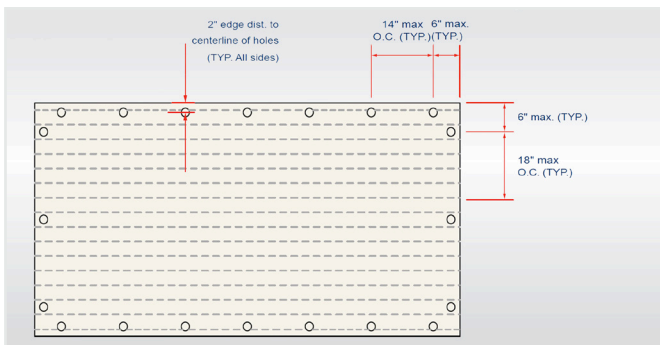

For patent information, please visit www.inteplast.com/patents

TEL: 1-800-452-2117 (x1)
 inteplast@inteplast.com
 www.inteplast.com

OFFICE: 9 Peach Tree Hill Rd., Livingston, NJ 07039
 PLANT: 101 Inteplast Blvd., Lolita, TX 77971